

- A This drawing is confidential and is the exclusive property of BARRATT R&L PLC. It is to be returned upon request.
- B Construct in full compliance with T202008 unless noted otherwise.
- C Scaffold built from steel tubes and steel fittings conforming to BS EN39 & BS EN74 unless noted otherwise.
- D All timber scaffold boards used are to be 225mm x 38mm thick in accordance with BS2462 unless noted otherwise.
- E Scaffold to be constructed using load bearing fittings throughout, except when using intermediate beams directly below platform levels and securing boards to trusses.
- F This drawing has been prepared from details supplied to us by the client. It is the client's responsibility to ensure that the design and erection sequences are correct and practicable. No alteration to the loading may be made without prior reference to design office.
- G The client is to prepare and ensure that any foundations/supports are suitable for the loads imposed upon it by the scaffold including its work load.
- H The design, lift methods or any (unless already shown) are to be added to the scaffold structure detailed on this drawing without prior reference to the design office.
- I The customer is to ensure that adequate facilities for lifting or anchoring the scaffold are made available and that the structure, building, ground or concrete foundation the scaffold is to be erected on is capable of withstanding the loads imposed on it.
- J No load or hoists are to be removed or any modifications to be made to the scaffold without prior reference to design office.
- K The engineer/client is to design, apply and fit all necessary safety equipment to the scaffold in accordance with the design office's specifications. The engineer/client is to ensure that such safety equipment is capable of withstanding the loads imposed on it.
- L The engineer/client will be responsible for setting out and final levelling of the scaffold.
- M All dimensions are as stated or as calculated. Drawings must not be scaled.
- N All fittings are to be as specified or as calculated. Drawings must not be scaled.
- O All working platforms must at all times be in compliance with relevant statutory regulations.
- P The client must ensure that the scaffold is erected in accordance with the design office's specifications and that the design office is notified of any changes to the design office.
- Q The construction Practice & Management Regulations 2007 require that an explicit statement of the design office's design office is to be included in the design office's design office. These details are detailed in the approved code of practice 'Managing Construction for Health & Safety'. Any queries should be addressed to the Design Office.

SPECIAL NOTES:

1. CLIENT IS TO CHECK & AGREE PRIOR TO ERECTION, THAT THE SCAFFOLD DESIGN IS SUITABLE FOR REQUIREMENTS.
2. THE CLIENT IS TO CHECK & ENSURE THAT ALL EXISTING FOUNDATIONS FROM STRUCTURES REMAINING THE APPLIED LOADS FROM THE SCAFFOLD PRIOR TO ERECTION.
3. ALL COUPLERS ARE TO BE LOAD BEARING EXCEPT BOARD BEARERS.
4. ALL COUPLERS ARE TO BE FITTED WITH TIEBOARDS AND QUADRAALS TO STATUTORY REGULATIONS.
5. CHECK FITTINGS ARE TO BE LOCATED IN POSITIONS SHOWN THUS: X
6. LASH DOWN ALL SHORT BOARDS AND ANY BOARDS IN EXPOSED OR UNUSUAL CONDITIONS TO (F) IN BOARD CONTACT DESIGN OFFICE
7. DIMENSIONS MAY VARY DUE TO SITE CONDITIONS. (F) IN BOARD CONTACT DESIGN OFFICE
8. ALL STANDARDS TO BE SEALED ON BASE PLATES AND SOLE BOARDS WHERE REQUIRED.
9. CONSTRUCTION RISK ASSESSMENT, MANUAL HANDLING ASSESSMENT AND METHOD STATEMENT REQUIRED PRIOR TO ERECTION TAKING PLACE.
10. SCAFFOLD TO BE ERECTED IN ACCORDANCE WITH: SCA-10, OR SPECIFIC RISK ASSESSMENT.

MAX LOAD ON ROOF TRUSS SUPPORT SCAFFOLD = 1.0 Tonne

**WORKING DRG**  
ISSUED FOR CONSTRUCTION

REV.	DESCRIPTION	DRAWN	DATE

**BARRATT**  
DEVELOPMENTS PLC

CLIENT: BARRATT DEVELOPMENTS PLC

SITE: VARIES

TITLE: GENERIC FREESTANDING KWIKSTAGE STORAGE RACK FOR TIMBER ROOF TRUSSES

P.B. SCAFFOLD DESIGN LTD.  
ICON BUSINESS CENTRE  
4100 PARK APPROACH,  
THORPE PARK, CO. LON.,  
LEEDS, LS15 8GB  
t: 0113 3970411  
m: 07825954822  
e: pb.scaffoldingdesign@btinternet.com

DATE: 5/7/12  
DRAWN BY: R.D.P  
APPROVED BY: P.J.B

SCALE: (A3) 1:50  
DRAWING No. BRT2002-1  
REV.

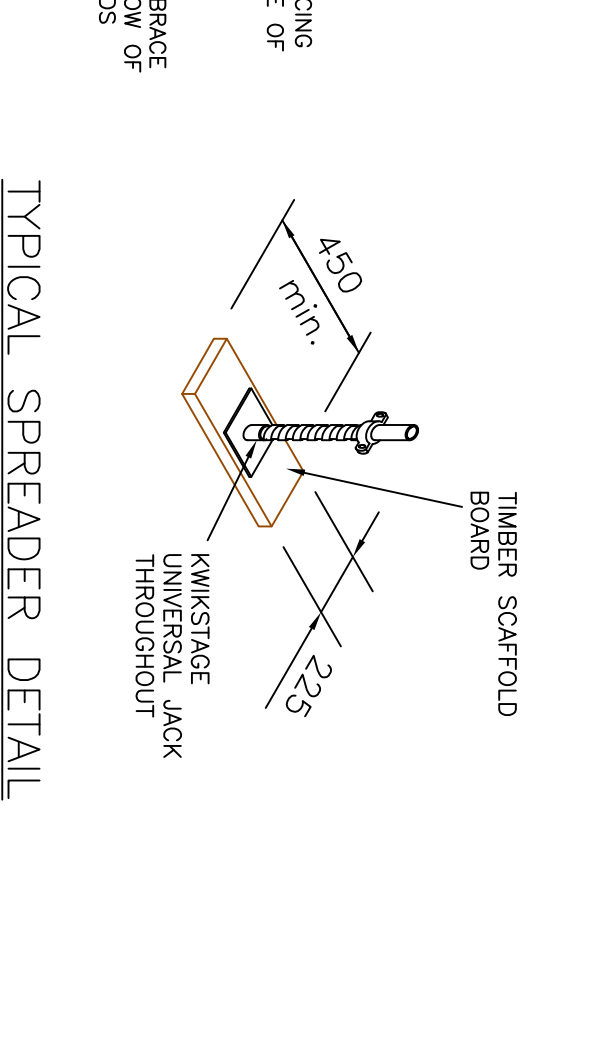
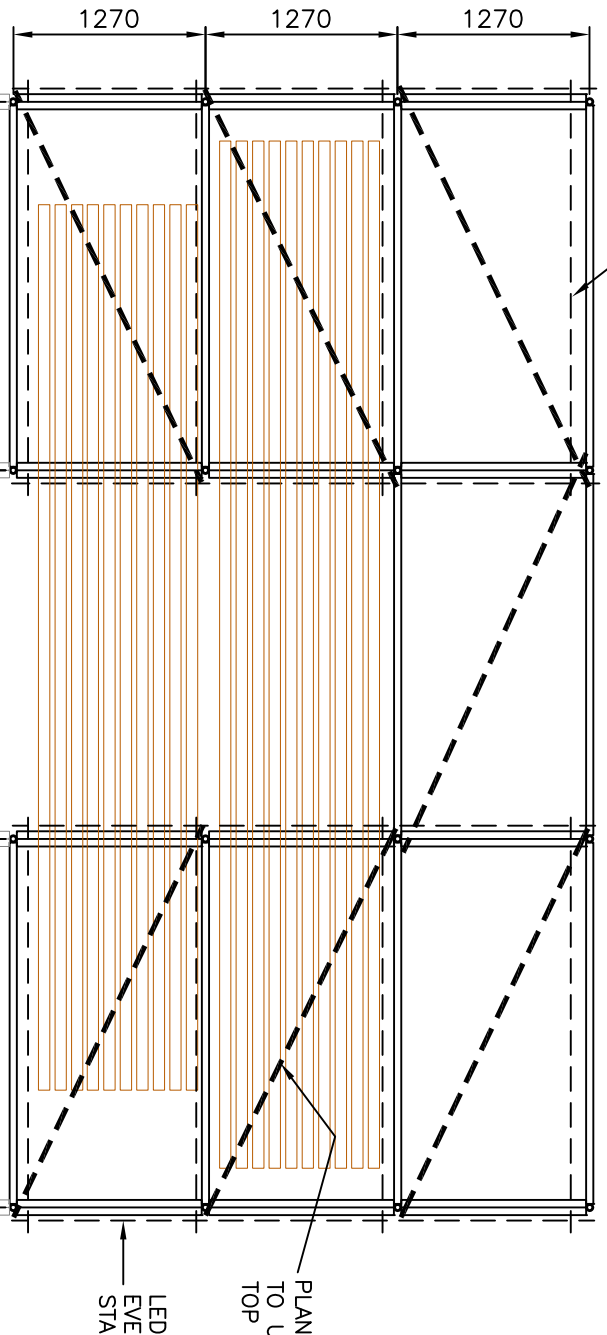
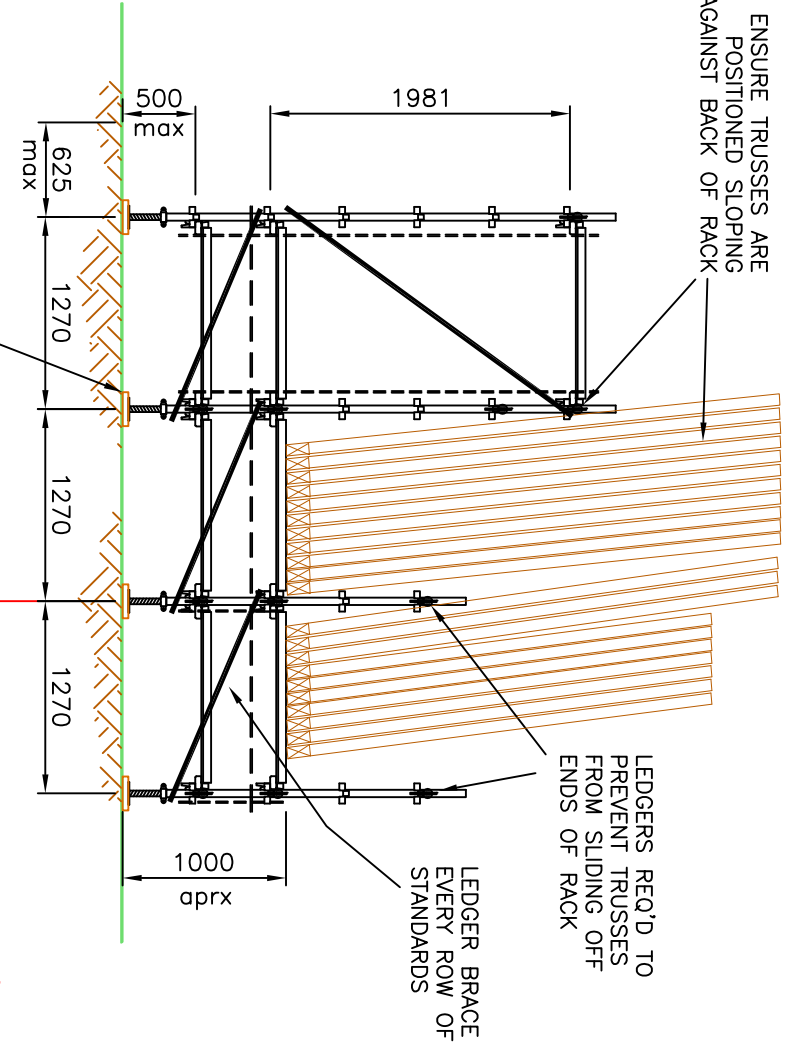
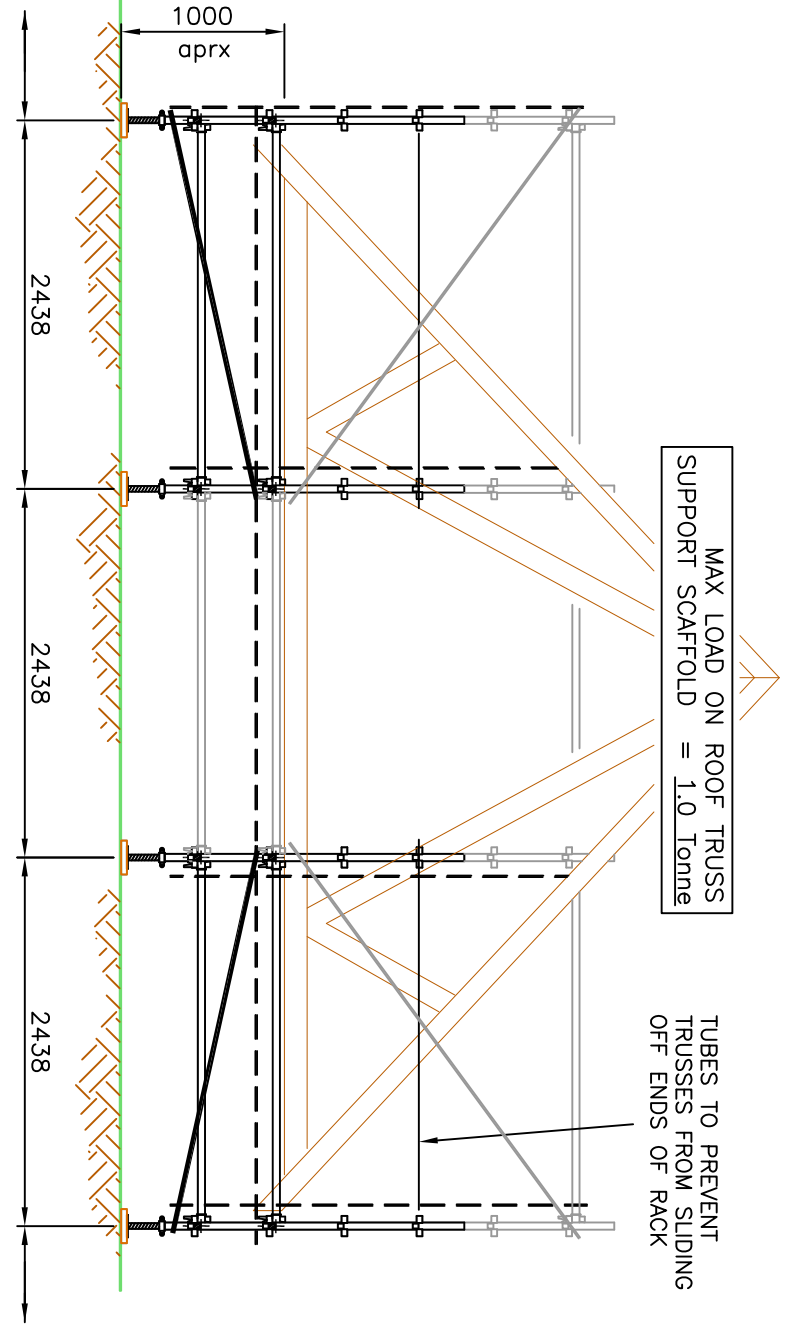

SCAFFOLD MAY BE EXTENDED BY ADDING ADDITIONAL BAYS. NEW BAYS MUST NOT EXCEED DIMENSIONS SHOWN ON DRG. THE ALLOWABLE LOAD FOR EACH NEW BAY = 500kg

**NOTE:**  
SCAFFOLD IS TO BE ERECTED USING GENUINE KWIKSTAGE PARTS IN FULL ACCORDANCE WITH THE OFFICIAL KWIKSTAGE USER MANUAL, SG4 & ALL STATUTORY REGULATIONS