



DAVID
WILSON
HOMES



BARRATT
DEVELOPMENTS PLC

Date:

Description:

Rev:

Brand: **BARRATT / DAVID WILSON HOMES**

Range: **-5 / 2010**

Title: **FIRE RATED DOWNLIGHT**

Detail No: **DB-SD09-003**

Drawn: **GDT**

Checked: **GDT**

Scale: **1:5**

Date: **Oct 14**

**THIS DETAIL CAN BE USED
WITHIN A FLOOR ZONE
WITHOUT INSULATION**

Refer to roof truss
manufacturers drawings for
sizes and setting out.

400mm fibreglass quilt roof
insulation between and over
bottom chord of roof truss.
Insulation to be positioned
above insulator separator on
downlight.

15mm Gyproc Ceiling board
(density 10kg/m²) with 3mm
skim finish or taped and jointed
fixed to bottom chord of roof
truss.

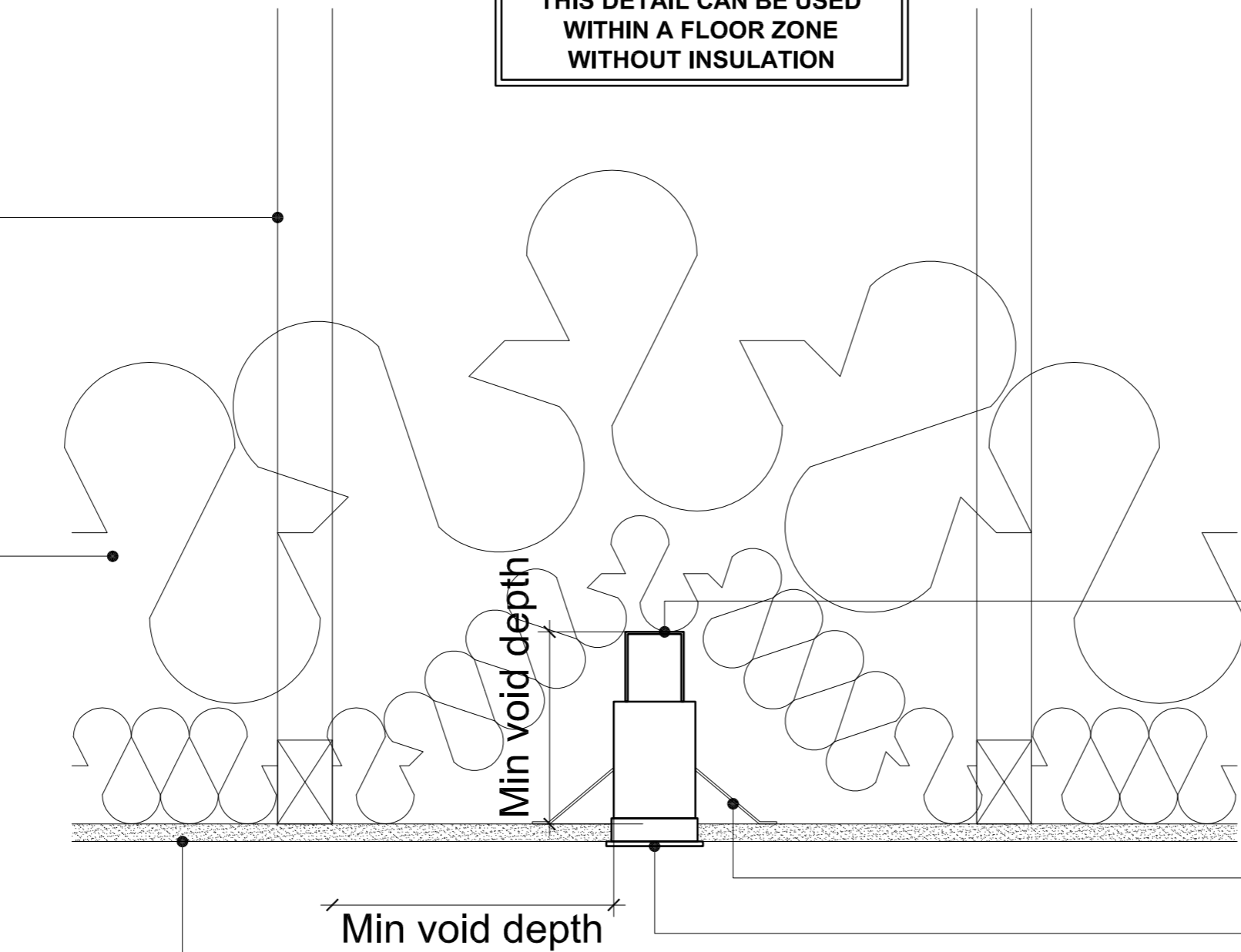

Insulator separator (part of the
downlight). Allows loft insulation
to be laid over the top of fittings.
For minimum void depth refer to
table below.

Spring clip.

Delta Fire Rated Downlights with
gasket on flange. Provides seal
to prevent movement of air, and
reduces passage of sound (Part
E of the Building Regulations).

**MINIMUM VENTILATION SPACE
OVER DOWNLIGHT TO BE
MAINTAINED AT ALL TIMES.**

Table for minimum void depths

	Fixed	Tilt	IP65
Cut-out ø	74	82	74
Min. Void depth	165	165	175
Bezel ø	83	95	87

**Minimum Void depth equals the
distance from any roof truss / floor
joist / insulation to the downlight.**

**FIRE RATED DOWNLIGHTS
TO BE FITTED FULLY IN
ACCORDANCE WITH
MANUFACTURERS
INSTRUCTIONS.**

EXTERNAL REFERENCE :